

Flash Screw

- LED Light Transmission technology fastener
- Fast navigate, allocate, positioning screw in a dark environment.
- ex.Data Center. Easy to operate , repair, maintenance.
- Smart fastening to alert loosen screw or any error warning.
- Fast detect faulty screw, easy to allocate and fix.

Flash Screw 99 Series patented.

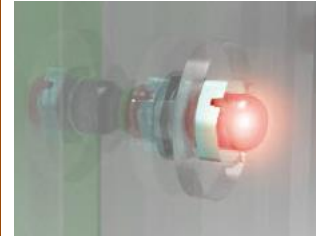

Material and Finish

Screw : 300 Series Stainless Steel, Natural Finish.

Guide Light : Plastic, Natural Finish.

■ Projection

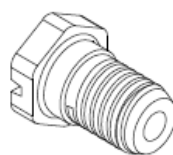
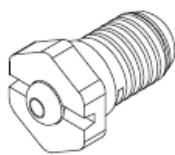
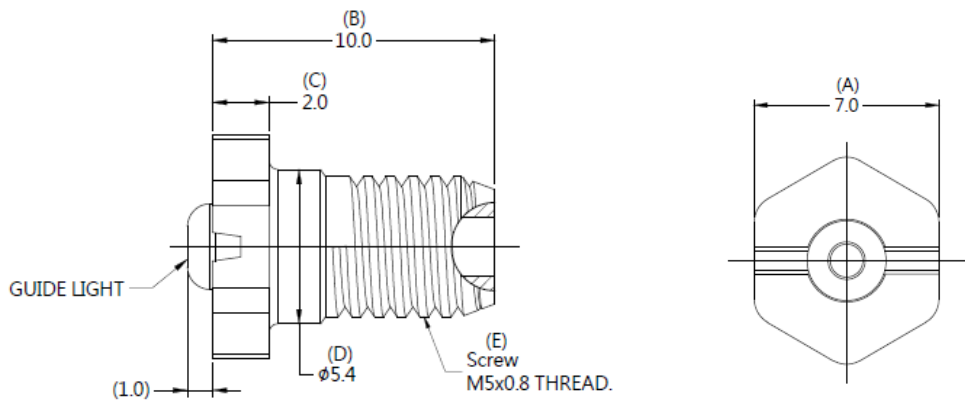

■ Dimensions(mm)

THREAD	SCREW PROJECTION						
	A	B MIN	B MAX	C MIN	C MAX	D MIN	D MAX
M5	7.0	6.4	~	2.0	~	φ5.4	φ6.0
M6	8.0	7.0	~	2.0	~	φ6.4	φ7.0